

PATENTS:

2025 3052 9529.1

PCT/CN2020/071260

2022 2355 4253.2

2020 3024 3743.8

3000C

Professional Cordless Hair Clipper

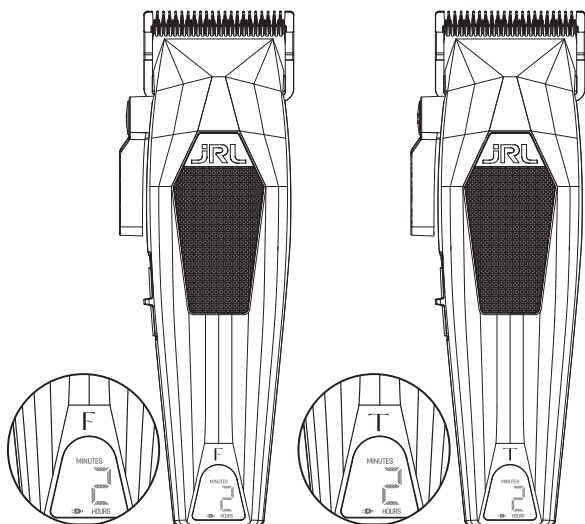

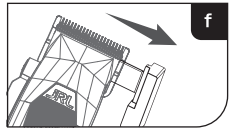
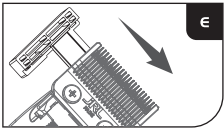
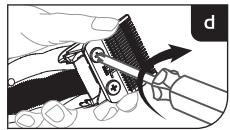
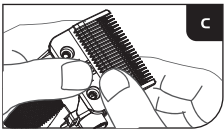
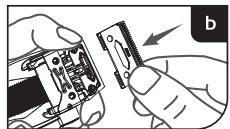
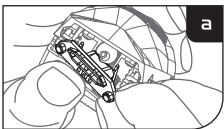
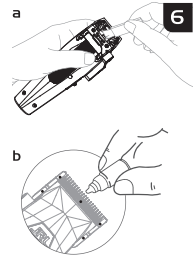
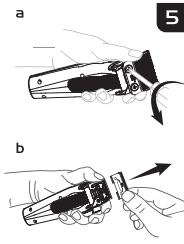
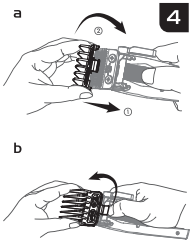
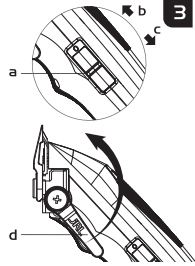
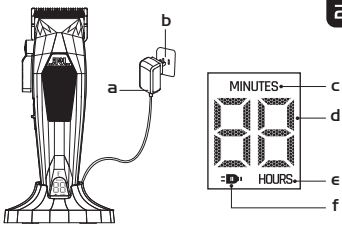
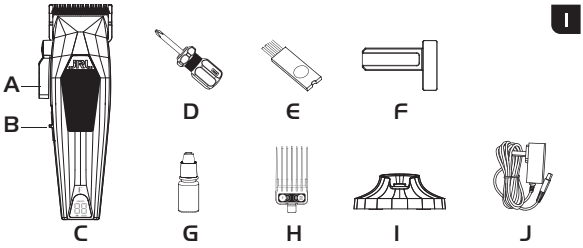

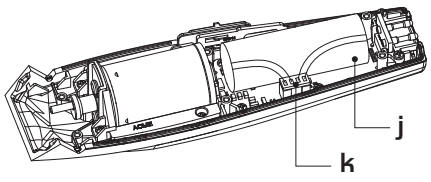
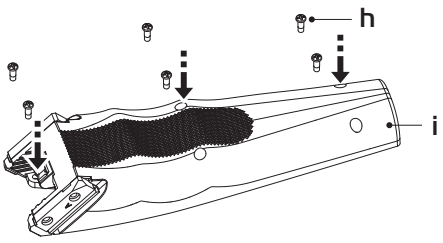
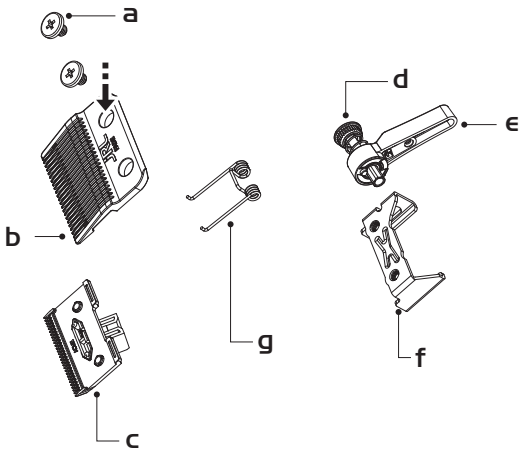

Tips

1. This product is designed for professional use only. This machine is not designed to be used on synthetic hair or for any other purpose other than cutting 100% human hair.
2. The company will not take responsibility for malfunctions or damages caused by misuse.
3. The safety instructions and the operating manual are also available in PDF format from our website: www.jrl.com.

Safety Precautions

Keep Away From Children:

Please store clipper away from children.

Clipper contains sharp blades and small parts that can be harmful to minors.

Safety Use:

1. This appliance can be used by children aged from 8 years and above and persons with reduced physical, sensory or mental capabilities or lack of experience and knowledge if they have been given supervision or instruction concerning use of the appliance in a safe way and understand the hazards involved.
2. This appliance is not intended for use by persons (including children) with reduced physical, sensory or mental capabilities, or lack of experience and knowledge, unless they have been given supervision or instruction concerning use of the appliance by a person responsible for their safety.
3. Children shall not play with the appliance.
4. Cleaning and user maintenance shall not be made by children without supervision.
5. The appliance is only to be used with the power supply unit provided with the appliance.
6. **WARNING:** Keep the appliance dry.
7. Unplug the power adapter before cleaning the clipper.
8. Remove the blade first, then use cleaning brush to remove any hair buildup.
9. Keep away from water in order to avoid shock or damage to the clipper.
10. If the clipper is accidentally dropped into water or any other chemicals, discard immediately. Do not try to dry it and plug it into a power source.
11. To properly store, remove clipper from dock, unplug adapter, and thoroughly clean your unit. Do not store the clipper on the charging dock or leave it attached to the adapter.
12. If the cord on the power adapter is damaged, stop using it immediately and replace right away.
13. Do not disassemble this product on your own. Visit authorized dealers for service and repair.
14. Choose the correct voltage socket before charging (AC100-240V 50/60Hz).
15. Please do not twist, disassemble or puncture the rechargeable battery within the clipper, otherwise it may cause a short circuit or burn the machine. If the battery is not working, do not run the clipper and take it to an authorized dealer.
16. Extended use in temperatures below -10°C or above 40°C is not recommended as it may damage the battery.
17.  detachable power supply part (apply to KA1201A-0502000EU/KA1201A-0502000BS/KA1201A-0502000AU model adapter)
18. Type of battery: Lithium ion battery
19. Dispose of used batteries according to local regulations. Do not throw into household waste; use proper recycling or collection points.
20. Avoid contact with leaking material. If contact occurs, rinse with water and seek medical advice. Use gloves and dispose of safely.
21. Do not expose the appliance or battery to excessive temperatures
22. Be aware of the risk of terminals of the battery-operated appliance or battery being short-circuited by metal objects.

To Avoid Product Damage:

1. Only use original accessories.
2. Do not sharpen the blade on your own.
3. **WARNING:** For the purposes of recharging the battery, only use the detachable supply unit provided with this appliance.

Product Overview (Fig.1)

- | | |
|--------------------------|--------------------------------------|
| A. Blade Adjusting Lever | F. Blade Adjustment Tool & Protector |
| B. Power Switch | G. Lubricating Oil |
| C. Clipper Unit | H. Set of 6 Guards (1.5mm-13mm) |
| D. Screwdriver | I. Charging Dock |
| E. Cleaning Brush | J. Charger Adapter |

Product Specifications

Product code: 3000C			
Item	Specifications	Item	Specifications
Power Adapter	Input AC 100-240V 50/60Hz	Type Of Battery	Lithium ion battery
	Output DC 5V 2A	Charging Time	2 hours
Battery Capacity	3.7V 2000mAh	Usage Time	2 hours

How To Charge Your Clipper



Important: Use Only Original Power Cord To Charge.

You can charge your unit on the portable charging dock, or charge the clipper directly by plugging the power cord to the clipper itself (Fig.2a/b).



Note: When the clipper is low on charge, the adapter can be plugged into the clipper directly. You may use the clipper while it is charging.

LED Indicator Description (Fig.2c/d/e/f)

- Charging (not full): The charging indicator  flashes.
- Remaining time < 40 min: the **JRL** warning light flashes red.
- Remaining time ≥ 40 min: the **JRL** warning light flashes white.
- Fully charged: The charging indicator  turns off; the **JRL** warning light stays solid white.

Usage Instructions

Switching And Shifting Instructions:

Push the switch to turn the clipper on and off (Fig.3a/b/c).

By pushing the switch, the speed of the clipper can also be adjusted:

O: Shutdown (off)

I: 7800 RPM

Clipper Status Indication By LED Light:

The battery indicator shows the usable time of the clipper in the current speed setting.

- When the clipper is in a high battery level state, the **JRL** light is solid white.
- When the remaining battery time is less than 40 minutes, the **JRL** light is solid red.
- When the clipper is in a low battery level state, the **JRL** light flashes red.
- When the battery is completely depleted, all indicator lights turn off and the clipper shuts down automatically.

Adjusting The Cutting Length

The clipper comes with 5 different adjustment levels, which are: 0.25/1.35/1.9/2.45/3.0mm. Users can adjust the level according to their needs.

- Push the blade adjustment lever (Fig.3d) forward for a closer cut.
- Push the blade back for the reverse effect.

How To Install And Replace Guards

Clipper comes with 6 guards.

Sizes are: 1/2#(1.5mm), 1#(3mm), 1-1/2#(4.5mm), 2#(6mm), 3#(10mm), 4#(13mm)

Installing Your Guard:

As shown in the Fig.4a, align the card slot corresponding to the guard with the main unit of the product, and then lift the main unit gently until you hear a 'click', which indicates the installation of the guard is complete.



Note: Before replacing guard, make sure the clipper is turned off.

Make sure the guard is installed properly, and is not loose before use.

Removing Your Guard:

As shown in the Fig.4b, you can remove the guard by turning the tail of the comb with your finger.

Blade Maintenance



Note:

1. Please read the blade maintenance Instructions carefully before operating. Follow the instructions when removing and installing the blade to avoid improper assembly.
2. After the blade is installed, be sure to carefully check whether the corresponding parts have been firmly attached.
3. Before operating, please unplug the power adapter and turn off the machine.
4. When handling the blade, do not try to sharpen or alter the blade by yourself to avoid damaging your machine.

Removing The Blade:

- Hold the clipper as shown in Fig.5a, loosen the screws shown, and remove the blade. When removing the blade, please hold the blade while holding the clipper to prevent the blade from falling and being damaged (caution: the blade is sharp. Pay attention to protect your hands).
- As shown in Fig.5b, remove the upper blade and the movable blade holder together.

Blade Cleaning And Maintenance:

Use a brush to clean the main body, the hair debris in the upper and lower blades and the movable blade (Fig.6a).

After the cutter head is installed, drip 1-2 drops of lubricant on the corresponding five areas (Fig.6b).

How To Install The Blade:

1. Install the movable blade on the two pins of the spring attachment (Fig.7a).
2. Put the upper blade on the movable blade firmly (no looseness) (Fig.7b).
3. The lower blade is pressed down firmly and aligned with the bottom screw hole (Fig.7c).
4. Insert the screw clockwise into the 3/4 depth (Fig.7d).
5. Insert the blade adjustment tool. Check that upper and lower blades are centered and parallel (Fig.7e).
6. Tighten the screws, take out the blade adjustment tool to complete the blade assembly (Fig.7f).

Battery Replacement Instructions

Warning

1. Before servicing, ensure the clipper is switched off and disconnected from the power supply.
2. Use only the battery specified by the manufacturer. Use of batteries with incorrect voltage, capacity, or specifications may result in malfunction, overheating, fire, or other safety hazards.

Caution

1. This appliance is equipped with a user-replaceable rechargeable battery. To avoid potential hazards, battery replacement or removal at end of product life should be carried out by the manufacturer, its service agent, or similarly qualified personnel.
2. Only use rechargeable batteries specified for this appliance.
3. Improper installation may cause safety risks or damage to the appliance.
4. Ensure that the battery is installed with correct polarity (+/-).
5. After installation, verify that all components are correctly installed and securely fastened before operation.
6. Do not crush, puncture, deform, disassemble, or short-circuit the battery pack. Do not use non-rechargeable batteries, as this may cause overheating, leakage, or explosion. Improper use of batteries may result in injury or damage to the appliance.

7 Battery Model: 18500

Battery Disposal

1. Do not dispose of the battery in household waste.
2. Dispose of used batteries in accordance with applicable local, state, and federal regulations.
3. Return used batteries to a certified battery recycling facility or an authorized JRL service partner.

Tools Required

- JRL screwdriver (included with accessories)

Battery Specifications

- Type: Lithium-ion (Li-ion)

Battery Removal

1. Refer to **Removing the Blade** and remove the upper and lower blades (Fig. 8a/b/c).
2. Using a screwdriver, loosen the blade-adjusting lever screws and remove the lever (Fig. 8d/e).
3. Remove the fixed bracket (Fig. 8f).
4. Remove the blade spring (Fig. 8g).
5. Loosen the bottom housing screws and remove the bottom housing cover (Fig. 8h/i).
6. Carefully remove the battery from the battery compartment (Fig. 8j).
7. Disconnect the battery cable from the connector (Fig. 8k).

Battery Installation

1. Connect the battery cable in the correct orientation. Once connected, the main indicator lights will illuminate. Press the power switch once to return the indicator to its normal operating status.
2. Ensure the battery cable connector is fully inserted and securely connected (Fig. 8k).
3. Position the battery correctly and secure it between the battery holder and the PCB (Fig. 8j).
4. Reinstall the bottom housing cover and tighten the screws securely (Fig. 8h/i).
5. Install the blade spring (Fig. 8g).
6. Install the fixed bracket (Fig. 8f).
7. Reinstall the rocker assembly and tighten the screws (Fig. 8d/e).
8. Refer to **Installing the Blade** to reinstall the upper and lower blades (Fig. 8a/b/c). After installation, verify proper blade alignment and ensure there is no looseness or misalignment before use.

JRL[®]
PROFESSIONAL

**Guang Zhou Eagle Fortress
Hair Products Ltd.**

No.4 Shuanglong Yucai
Street, Shiling Town, Huadu
District, Guangzhou, 510899
China



www.jrl.com

Bratt Trading AB

Radiovägen 34
135 48 Tyresö SWEDEN
+46 (8) 712 95 10
info@bratt-trading.se
www.bratt-trading.com



www.bratt-trading.com



EAC

UK
CA

CE

